

MAP REFERENCES:

1. TOPOGRAPHIC AND PLANIMETRIC SITE INFORMATION OBTAINED FROM A DIGITAL PLAN (copake.dwg)
BY: COL-EAST, INC., DATED MARCH 2, 2005.

2. PROPERTY SURVEY AND ADDITIONAL PLANIMETRIC SITE INFORMATION OBTAINED FROM A DIGITAL PLAN
(COPAKE VILLAGE LLC.dwg) SURVEY OF PROPERTY OF COPAKE VILLAGE, LLC TOWN OF COPAKE COLUMBIA
COUNTY, NY BY: ALVIN B. HUEHNEL NYSLS LIC. NO. 48356 491 MARTINDALE ROAD CRARYVILLE, NY 12521 TEL:
(518) 851-5834 DATED: FEBRUARY 24, 2005.

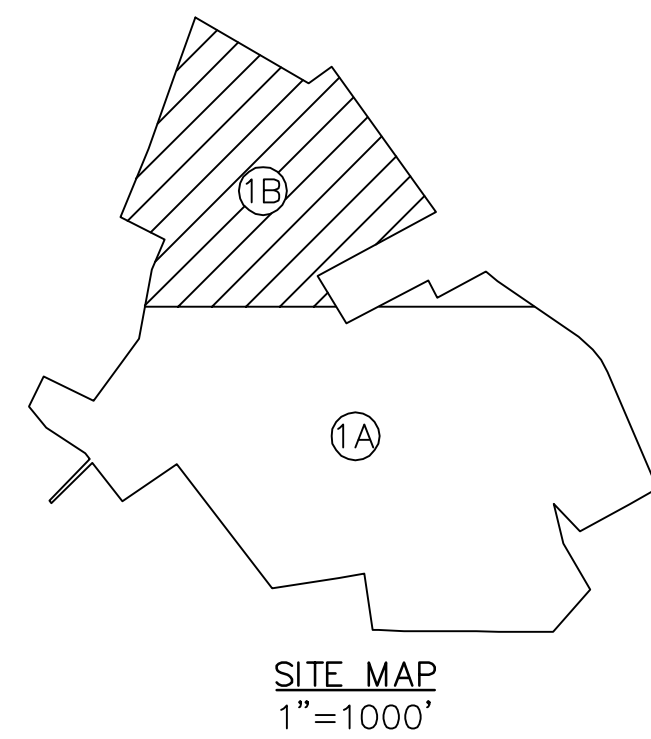
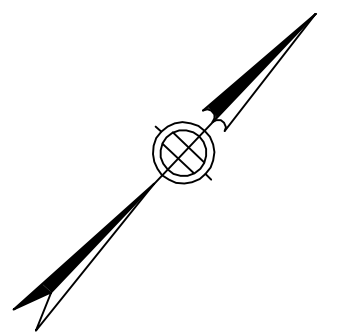

LUGS: WRLD | IMS VIEW: 100 | LMAN: C.1A-B-EXIST | CTB: F&O STANDARD

No.	DATE	DESCRIPTION	BY
1.			
REVISIONS			

PROJ. MANAGER:	EB
CHIEF DESIGNER:	GMT
REVIEWED BY:	DATE
	EB

SEAL	SEAL
------	------

ARCHITECTURAL BUREAU
JOE IUVIENE AIA
 P.O. BOX 238 - 29 MAIN STREET
 CHATHAM NEW YORK 12037
 (518) - 392 - 3650

SCALE:	HORZ.: 1" = 100'
	VERT.: N/A
DATUM:	HORZ.: NAD83
	VERT.: NAVD88
GRAPHIC SCALE	

FUSS & O'NEILL
 of New York, pc
 80 WASHINGTON STREET SUITE 301, POUGHKEEPSIE, NY 12601
 845.452.6801 www.FandO.com

HOUSING RESOURCES OF COLUMBIA COUNTY
SITE SURVEY 1B
 COPAKE GREEN
 COPAKE COLUMBIA COUNTY, NEW YORK

PROJ. No.: 20040402.A3N
 DATE: APRIL 3, 2006
C1.1B